

State of ^{South} Carolina,

(19)

Pursuant to a warrant from John Thomas Esq. Commissioner of locations, dated 1st Dec^r 1787, I have admeasured and laid out unto John Jay a tract of 42 acres of land in 3^d District on waters of Beaufort a branch of Saluda River, and hath such shape, marks, ballings & boundings as the above Plat represents, Survey^d 26th Dec^r 1787. J. W. Wright Esq.
Recorded 16th Jan^y 1788, J. P. M^r Wadsworth



State of ^{South} Carolina Pursuant to a warrant from John Thomas Esq. Com^r of locations & Saluda I have admeasured and laid out unto Samuel Dunaway a tract of two hundred & two acres of land in 7th District on the branches of Saffold's Creek, bounded to by Holdens land, all other sides vacant land, having such shape form & marks as the above Plat represents.
Survey^d 20th May 1788. Vardry M^r Bee Esq.
Recorded 11th June 1788,

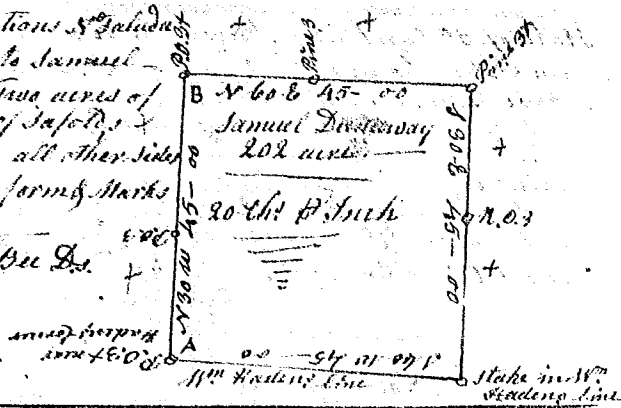

State of ^{South} Carolina Pursuant to a warrant from John Thomas Esq. Commissioner of locations & Saluda River, I have admeasured and laid out unto Jonathan Gibbs a tract of one hundred & thirty seven acres of land on Saffold's Creek bounded N^e by north Carolina line, to Markley's land E^t Clark's land, N^e Borins land & N^e W^e, and hath such shape, form and marks as the above Plat represents, Survey^d 30th May 1788. Vardry M^r Bee Esq.
Recorded 10th June 1788,



State of ^{South} Carolina Pursuant to a warrant from John Thomas Esq. Com^r of locations & Saluda I have admeasured and laid out unto Abraham Markley a tract of six hundred and twenty four acres of land in 10th District on Saffold's Creek waters of Broad River, bounded N^e by Jonathan Gibbs land & N^e Borins land N^e by Frank Clark's land S^e by Swans land, to by N^e Rights land and Gutrys land, W^e vacant land, having such shape form & marks as the above Plat represents.
Survey^d 16th May 1788. Vardry M^r Bee Esq.
Recorded 11th June 1788

